

- MATERIAL:
 - OUTER - .018 THICK, G-90 GALVANIZED STEEL
 - INNER - .012 THICK, ALUMINUM SIZES 3 THROUGH 6
 - INNER - .016 THICK, ALUMINUM SIZES 7 THROUGH 12

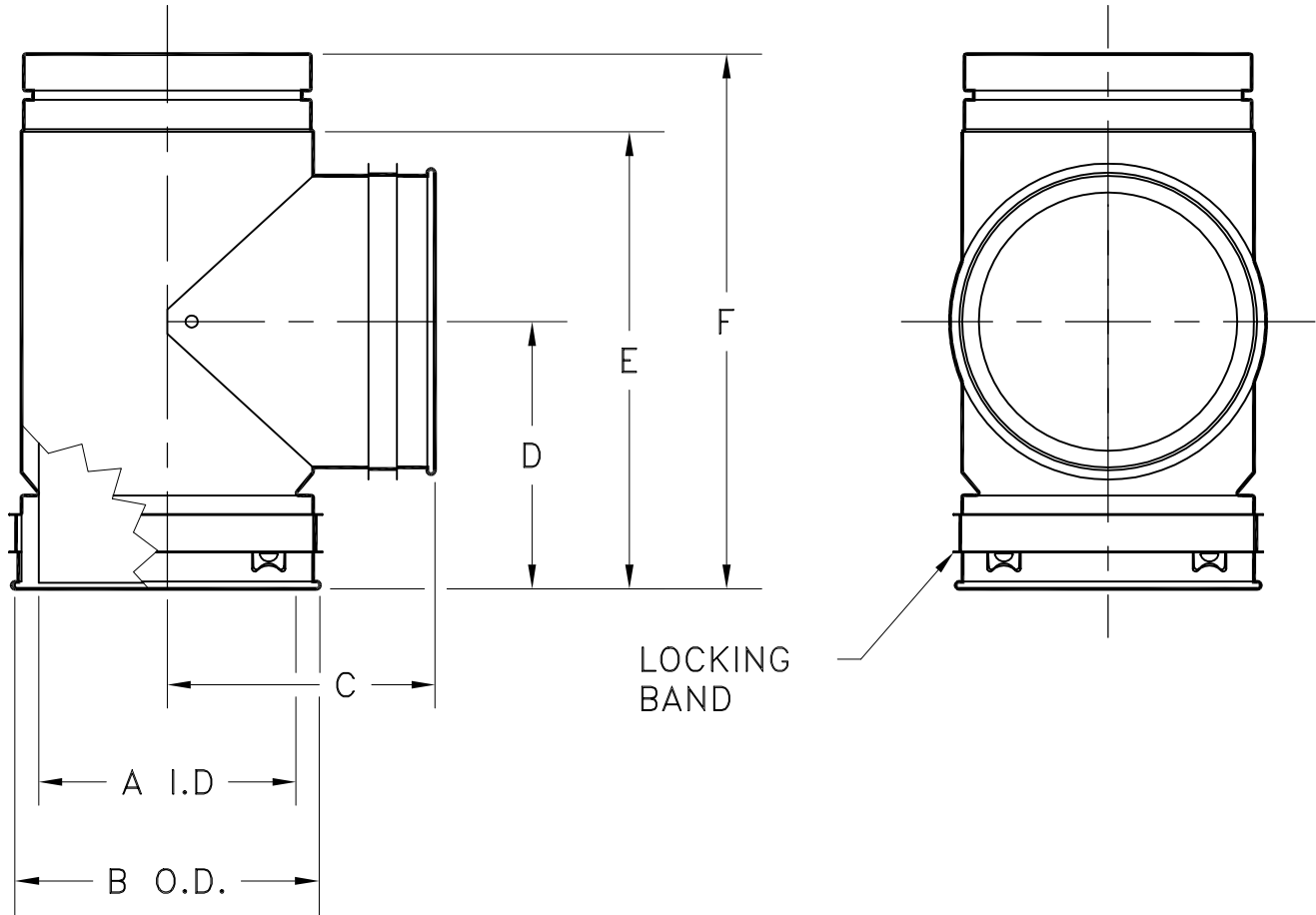

CAT. NO.	A I.D.	B O.D.	C	D	E	F
3RT3	3	4	4-1/2	4-1/2	7-5/8	9
4RT4	4	5	5	5	8-5/8	10
5RT5	5	6	5-1/2	5-1/2	9-5/8	11
6RT6	6	7	6	6	10-5/8	12
7RT7	7	8	6-3/4	6-3/4	12-1/8	13-1/2
8RT8	8	9	7-1/4	7-1/4	13-1/8	14-1/2
10RT10	10	11	8-1/4	8-1/4	15-1/8	16-1/2
12RT12	12	13	9-1/4	9-1/4	15-1/8	16-1/2

JOB NAME: _____	SUBMITTED BY: _____	DATE: 2/1/99	SD-3110
LOCATION: _____		Type B Gas Vent	
ARCHITECT: _____		Tee	
ENGINEER: _____		RT	
CONTRACTOR: _____		3" - 12" Diameter	